

Proposed Project at Premises No-28 H, Raja Subodh Chandra Mullick Road, Ward No-096, Borough-X, under Kolkata Municipal Corporation, P.S.-Jadavpur, Kolkata-700032

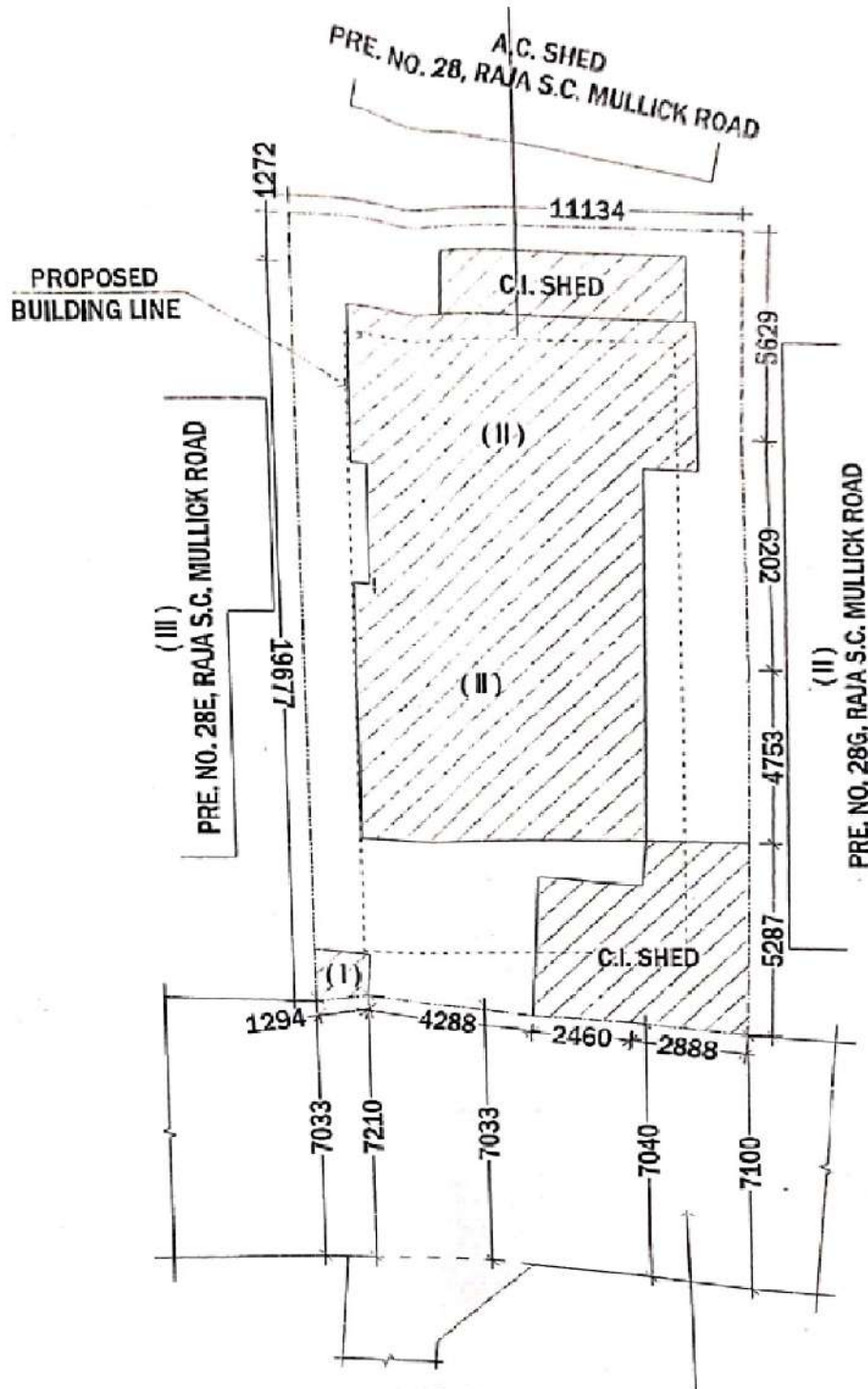

LATITUDE : 22.497310

LONGITUDE : 88.350714

ANGEL NEST
Partner

SIGNATURE OF OWNER